



18 Winsdale Road

Great Family Home in Markland Wood Community.
 Spacious Principle Rooms, 3 + 1 Bedrooms, Walk-out to Fenced Garden.
 Close to Schools, Shopping & Golf Course. Easy Subway, Highway & Airport Access!



INCLUSIONS

All Electric Light Fixtures,
 All Window Blinds & Curtains,
 Hardwood under Broadloom
 in Living/Dining Room,
 Refrigerator, Wall Oven, Cook Top,
 Built-in Dishwasher,
 Exhaust Hood, Washer, Dryer,
 Furnace, Central Air



LOT SIZE - 48.5 x 109.08 Feet

TAXES - \$4,684.06 (2017) **POSSESSION** - 90 Days /TBA

PARKING - Private Double Drive, Attached Garage

Cathy Graham, Sales Representative

www.CathyGraham.co
 CathyGraham@Rogers.com



416 236.1241 Direct 416 722.7158

Years of Proven Performance...Makes The Difference





Floor Plan

 18 Winsdale Road

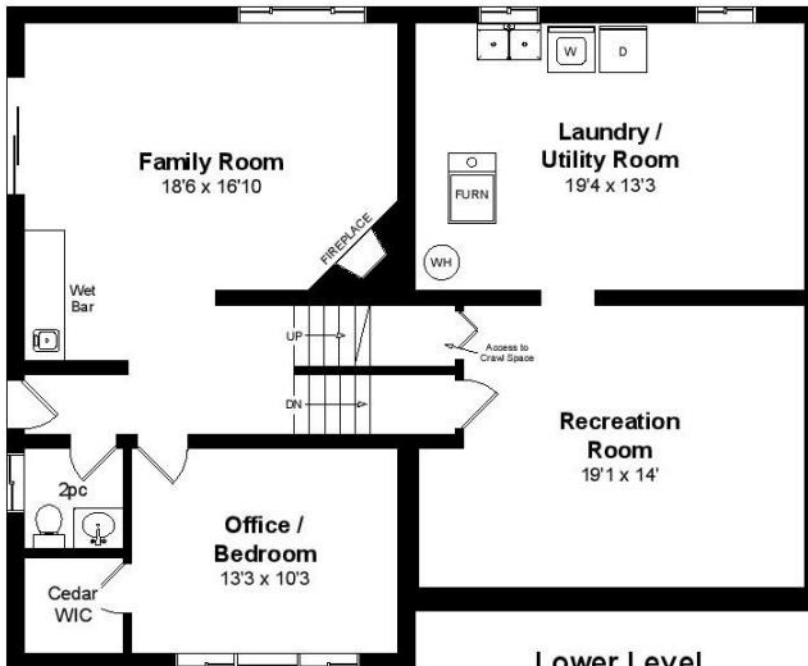

Upper Level

Main Level



Ground Level

Lower Level

Approximate Square Footage:

- Main Level = 625 sq.ft.
- Upper Level = 654 sq.ft.
- Ground Level = 654 sq.ft.
- Lower Level = 625 sq.ft.
- Garage = 336 sq.ft.

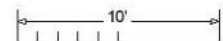

Note: Measurements may not be 100% accurate and should be used as a guideline only.
February - 2018